

RESISTIVE LINEAR POSITION TRANSDUCER

Application:

- The resistive linear position transducer MLPS is mainly used in general automation applications.



- Measuring range 30mm-150mm
- Excellent repeatability
- Infinite resolution

Congestion:

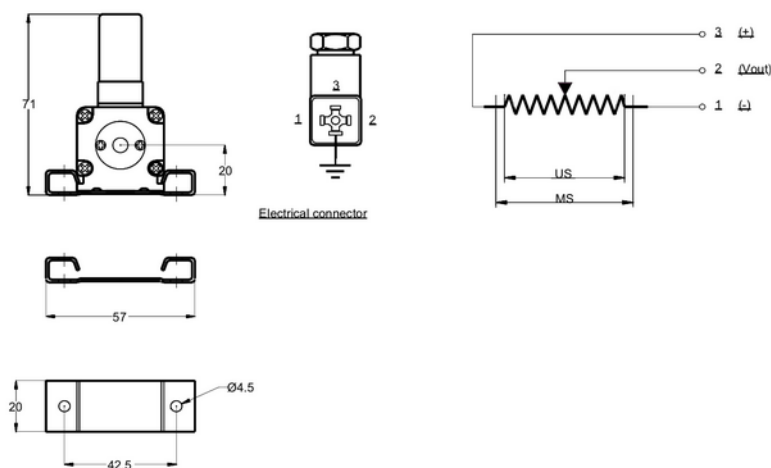

Model	LM	Mechanical stroke (MS)	Useful stroke (US)	Total length (L)
MLPS	30	34 mm	30 mm	232 mm
MLPS	50	54 mm	50 mm	277 mm
MLPS	75	79 mm	75 mm	337 mm
MLPS	100	104 mm	100 mm	397 mm
MLPS	125	129 mm	125 mm	449 mm
MLPS	130	134 mm	130 mm	457 mm
MLPS	150	154 mm	150 mm	497 mm

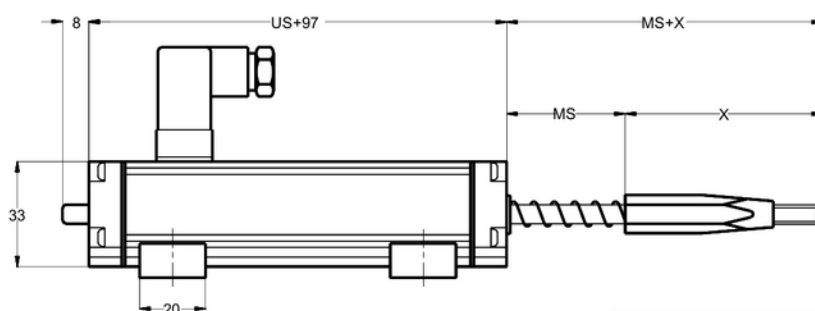

	MLPS 30	MLPS 50	MLPS 100
X	63mm	68m	88mm

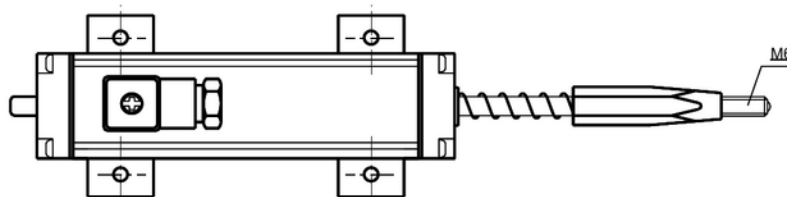

Technical specification	
Mechanical stroke	30mm to 150mm
Independant Linearity	± 0,1 % (130-150mm), ± 0,2 % (75-130mm), ± 0,5 % (<75mm)
Resolution	Infinite
Resistance output	5kΩ
Resistance tolerance	±% 20
Load resistance	Min: 100kΩ
Repeatability	≤% 0.01
Mechanical life	100x10 ⁶ cycles
Displacement speed	≤ 1.5 m/s
Permissible applied voltage	28 VDC max
Recommended cursor current	Ⓢ < 1μA
Electrical connections	4 pole connector
Case dimensions	33mm x 33mm
Case material	Anodized aluminum
Rod diameter	6mm
Rod material	Stainless steel
IP Degree	IP 54
Working temperature	-20°C to +80°C
Mechanical fixing	Variable brackets

Model	Electrical stroke (mm)	Linearity (%)	Ohm value (Ω)	Connection / Cable
MLPS	125	D	5k	C2
MLPS	30...150 mm	D : Standard linearity	5k : 5kΩ	C2: 4 pin connector

→ **Note** : Fixing brackets included.